



LEAK FREE
SHOWER
ENCLOSURES

LESS-ABLED
BATHING
SOLUTIONS

WALK-IN
BATHS



LEAK FREE SHOWER ENCLOSURES

WALK-IN BATHS

Neptune Bathing was formed in 2009. The company's first product was the Leak Free Shower Enclosure. This came about due to the recognition of a very common problem: Leaking Showers!

Most showers leak at some stage in their lifetime, the damage can be quite expensive and difficult to fix. The only real solution, is a Leak Free Shower Enclosure.

Neptune Bathing is the market leader in Leak Free Shower Enclosures.

Easy to install and maintenance free,
LEAK FREE for life.



Our customers say it best..

Best thing ever. No water gets through the wall so none of the problems related to that. I have a 1200 X 900 now over 3 years. Still looks like new due to the finish of the unit.

Mark Gunian, Homeowner.

They are a great product. For one thing they don't leak and secondly they look great. From my point of view and from the customers too the speed in which you can install them is a huge advantage. The turn around time is one day. Much quicker than tiles and tray and no trouble later. I am more than happy to recommend them to any of my Customers.

Aidan Kennedy, Craig Contracts, Dublin.

We install Neptune Leak Free Enclosures in all our developments including Lakeside in Coleraine and Garrow Hill in Moneymore. They deliver on their promise of no leaks and a hassle free installation. They are easy to clean and hygienic and because of that our customers love them.

Seamus Feighan, Site Manager.

LEAK FREE SHOWER ENCLOSURES



OUR RANGE OF SIZES

- 800mm Quad and Square
- 900mm Quad and Square
- 800mm 3 sided Alcove
- 900mm 3 sided Alcove
- 1000mm x 800mm 3 sided Alcove
- 1200mm 3-sided Alcove
- 1200mm x 800mm Rectangular Left & Right
- 1200mm x 800mm Offset Quad Left & Right
- 1200mm x 900mm Rectangular Left & Right
- 1200mm x 900mm Offset Quad Left & Right
- Bespoke sizes also available for quantities

Most leaks happen where the wall and tray are joined. Our product is moulded and has no join at the back of the tray.

NO JOIN = NO LEAKS

WHAT'S IT MADE OF ?

Surface is an Isophthalic, Anti-bacterial Gel. This gives it excellent physical strength properties, excellent handling characteristics, easy clean, high heat resistance and outstanding corrosion resistance. Behind the surface coating is a high-end GRP (Glass Reinforced Polymer) of a grade normally only used in Ocean-Going Yachts. This will ensure many, many years of trouble free, water resistant showering.

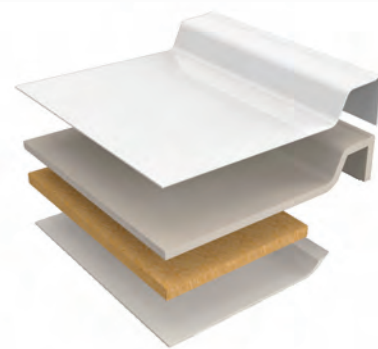

Behind the GRP is a special Resin Infused Particle Board. This gives the product extra rigidity and strength and allows for the shower doors, valves and additional accessories to be attached directly to the unit without having to go through to the wall behind. Behind the RIPB is another coating of GRP. This encapsulates the entire unit and makes it impregnable to moisture.

Enhance your bathroom
with real luxury...



LEAK FREE SHOWER ENCLOSURES

WALK-IN BATHS



AVAILABLE IN DIFFERENT COLOURS AND EFFECTS

Porcelain White to complement your existing ware and 'never go out of style'

Sandstone Granite for a luxurious, warm effect.

Black Granite for a striking, modern finish or

Burgundy Granite for something a little bit different



PORCELAIN WHITE



SANDSTONE GRANITE

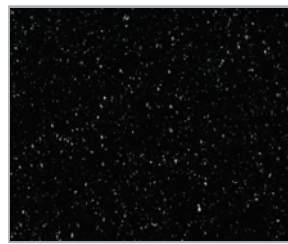

BLACK GRANITE

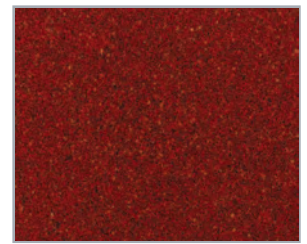

BURGUNDY GRANITE

Colours shown are for illustration purposes only.
Please ask instore for an exact colour swatch.



The future of showering is here

*A modern, low level tray
for ease of entry,
with no compromise
on water retention*

*Available in 2 or 3 part
systems for easy access
to your bathroom*

Also available with
Leg-Lifting-Kit and Fascia



Feel younger with our walk-in baths...

Our micro-bubble system creates a white-water effect with millions of tiny bubbles exploding against your skin and hair follicles for a really deep clean.

WALK IN BATHS

Our new Micro-Bubble Spa System is the very first in Ireland and the UK. The millions of micro-bubbles explode near the skin for a really deep clean. This is especially good for skin conditions such as Eczema and Psoriasis.

Makes you feel
relaxed, refreshed
and younger...

Built on a sturdy Stainless Steel frame, we have a non-porous acrylic shell which resists mould, stains and wear spots.

The design allows for easy access for wheelchair users as transferring across onto the seat is unrestricted.

The door lock is very easy and safe to operate. Lock and seals come with a lifetime guarantee.

At 840cms we have the widest door available making it so easy to access for persons with severe mobility problems.

Why not relax in a luxurious, deep-water Neptune Walk-in Bath?

Step inside the wide side door, make yourself comfortable on the moulded, contoured seat and sit back fully supported. Enjoy warm spray jets, with millions of micro-bubbles exploding against your skin. Mood lighting and music if you choose. Heaven.



Accommodates user weight up to 35 stone

THE OAKHAM RANGE



The Standard

A straightforward bath including 2 grab rails. 2" waste fitting.

Add your own taps and accessories for full flexibility and choice.

Built on a sturdy stainless steel frame. Accommodates user weight up to 35 stone

Available in 2 Sizes:

66 1300 x 660 x 950mm
75 1300 x 750 x 950mm

The Plus

As the Oakham Standard, with a full tap and shower set, headrest and water jet package.

Rest your head on the soft headrest.

Enjoy the invigorating waterjets... lovely

Available in 2 Sizes:

66 1300 x 660 x 950mm
75 1300 x 750 x 950mm

The Special

As the Oakham Plus with micro-bubbles spa, chromotherapy light, heated back and seat area, aromatherapy.

Good for eczema, psoriasis and other skin ailments. Water stays warm for up to an hour.

Available in 2 Sizes:

66 1300 x 660 x 950mm
75 1300 x 750 x 950mm

THE STAMFORD

Inward Opening Door



As with the Oakham, this bath has the superior box section and stainless steel frame.

With grab bar and pop up waste.

Add your own taps for full flexibility.

Available in 2 Sizes:

66 1300 x 660 x 950mm

75 1300 x 750 x 950mm



LEAK FREE SPECIFICATIONS

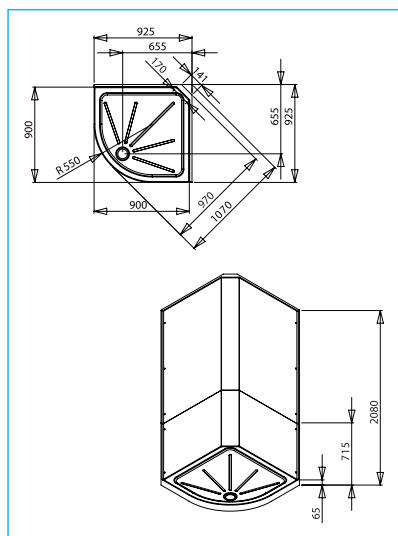

900 Quadrant

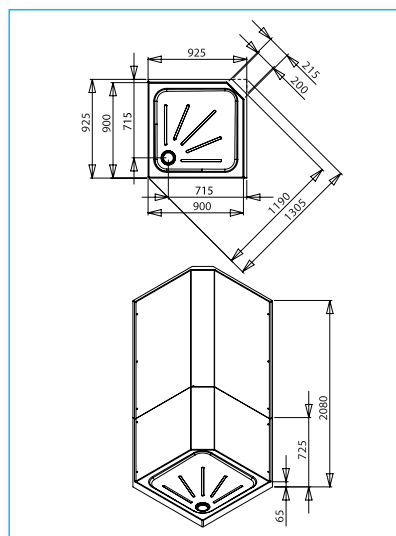

900 Square

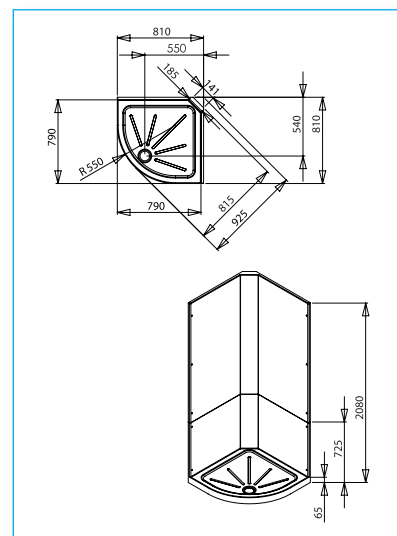

800 Quadrant

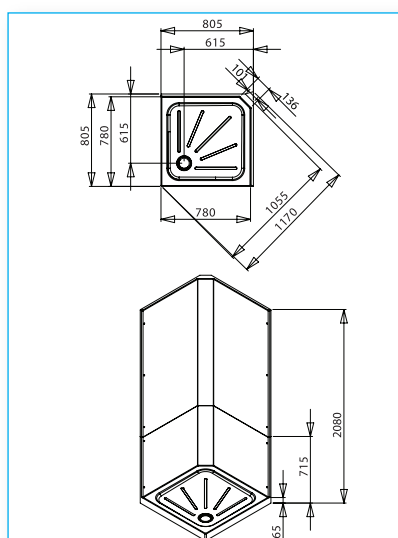

800 Square

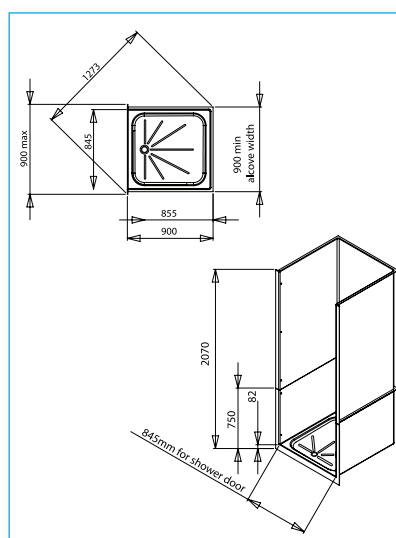

900 Alcove

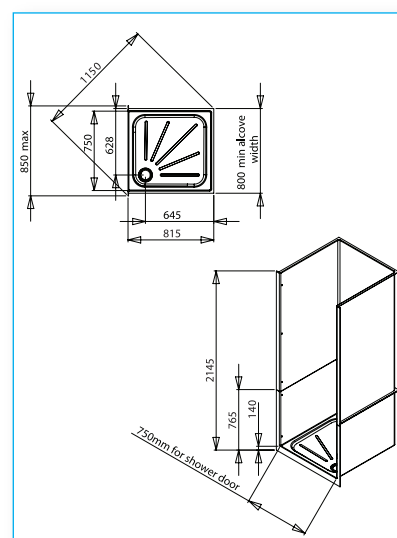

800 Alcove

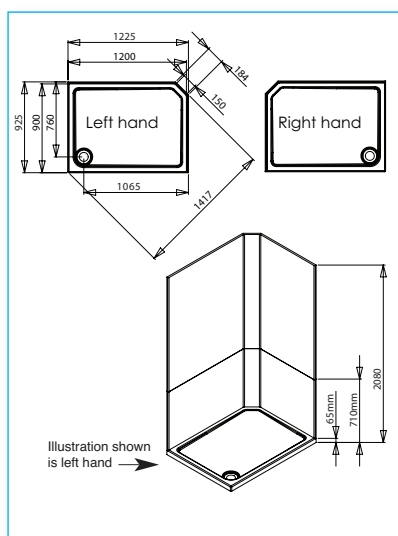

1200x 900 Rectangle

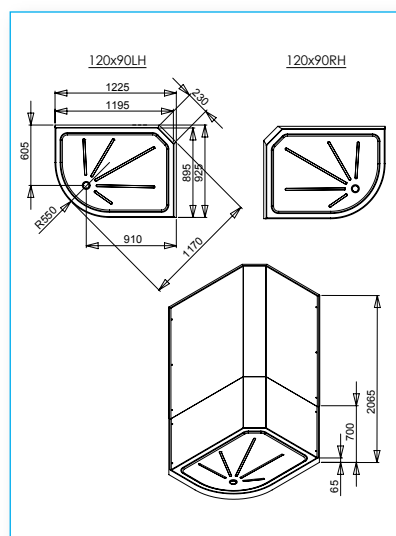

1200x 900 Quadrant

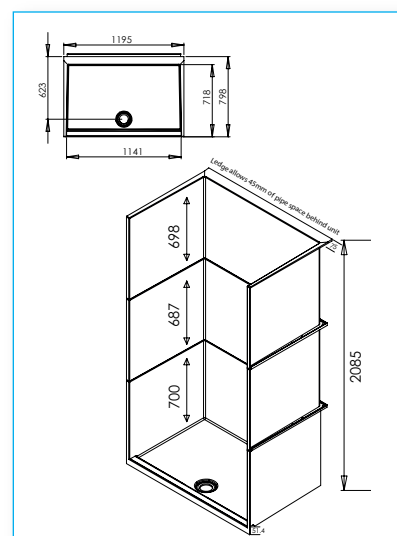

1200x800 Alcove

LEAK FREE SPECIFICATIONS

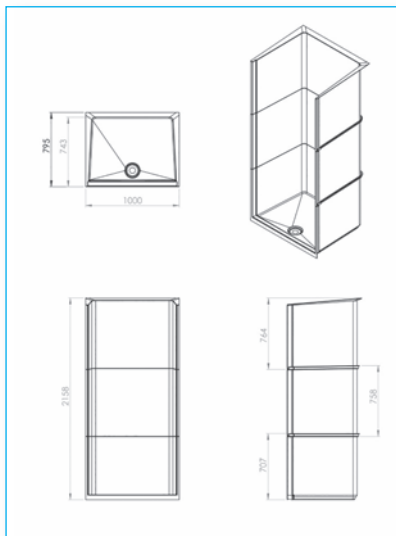

1000 x 800 Alcove

Also available with roof

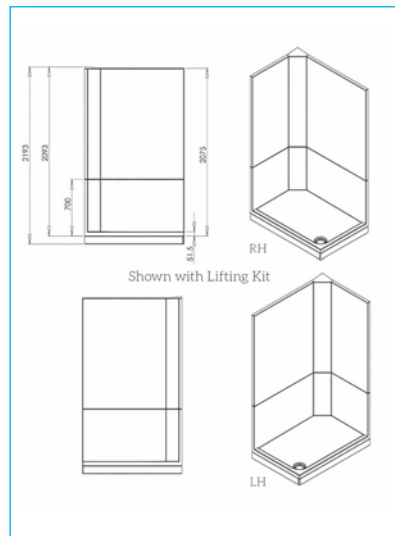

1200 x 800 Rectangle

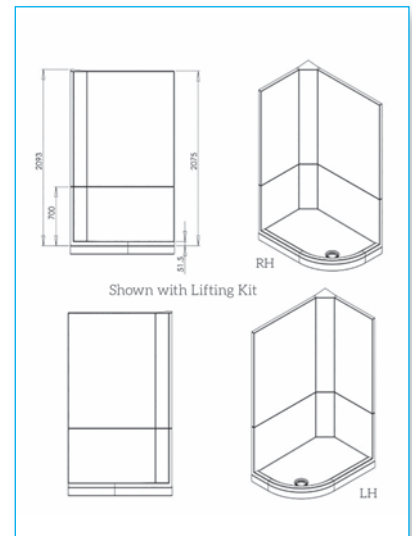

1200 x 800 Quadrant

WALK-IN BATH SPECIFICATIONS

Oakham

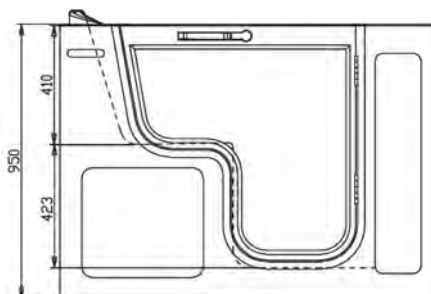

Front view for Oakham Range
Right hand model shown

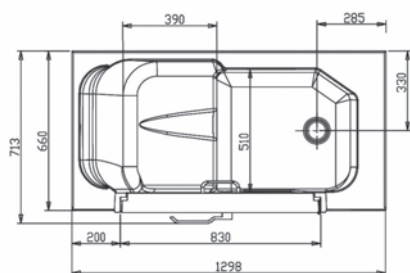

Oakham 66

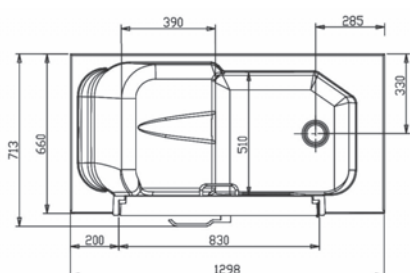

Oakham 75

Stamford

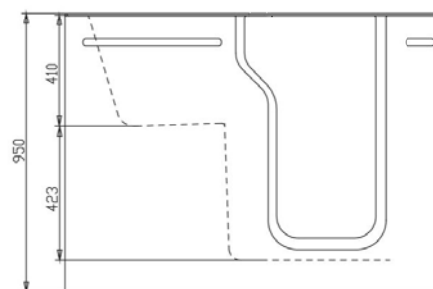

Front view for Stamford Range
Right hand model shown

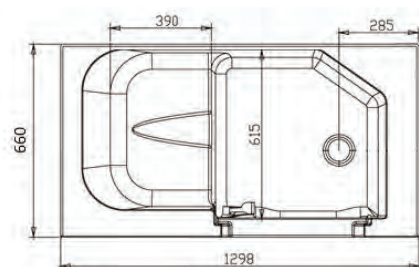

Stamford 66

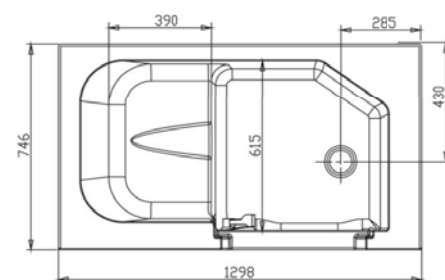

Stamford 75



Unit 54, Ardlea, Dunshaughlin, Co. Meath.
Tel: 00353 (0) 1 825 0840 • Fax: 00353 (0) 1 526 1006
ROI Mobile: 00353 (0) 85 888 8033
email: info@neptunebathing.ie • Website: www.neptunebathing.ie

